

# Leviton Load Center Branch Circuit Breakers



## APPLICATION

The most advanced circuit breakers on the market are also faster to install. Only Leviton circuit breakers feature an all plug on design, so you can wire the entire panel at rough-in, without a single circuit breaker present.

Intuitive diagnostics such as LEDs on electronic circuit breakers indicate fault type and color indicators in each rocker handle display operational status at-a-glance.

For circuit breakers 70A and higher, terminals on the breaker allow for direct wiring and the neutral is wired directly onto the panel neutral bar.

## FEATURES AND BENEFITS

- **Simple:** Features an all plug-on installation - no wiring to circuit breakers up to 60A for copper wire and 50A for aluminum wire
- **Intuitive:** Line-side powered LEDs stay lit, even after a circuit breaker has tripped, and identify cause of trip: Arc Fault (series or parallel), or Ground Fault. Color indicators in each rocker handle designate operational status at-a-glance (ON/OFF/Tripped)
- **Approachable:** Contemporary aesthetic and rocker style handle are more user friendly

### Leviton Mfg. Co., Inc.

201 North Service Road, Melville, NY 11747 Tech Line: 1-800-824-3005 Fax: 1-800-832-9538 [www.leviton.com](http://www.leviton.com)  
 © 2023 Leviton Manufacturing Co., Inc. All rights reserved. Subject to change without notice.

# PRODUCT SPECIFICATIONS

## PRODUCT FEATURES

Dimensions: Single Pole 3.9" H x 1.0" W x 3.1" D  
 Double Pole 3.9" H x 2.0" W x 3.1" D  
 Warranty: 10-Year Limited, 2-Years for electronic components  
 Weight: Single Pole 0.42 lbs.  
 Double Pole 0.85 lbs.  
 Wiring: All Plug-on

## Electrical Specifications

Amperage: Refer to catalog number tables  
 Breaker Technology: Thermal Magnetic / Hydraulic Magnetic\*  
 Short Circuit Current Rating: 10 K, Series Rated 22KA with Leviton Main Breaker; see Series Ratings Tables for additional Ratings  
 Type: Available in Standard, AFCI, GFCI, AFCI/GFCI, GFPE

Thermal Magnetic Operating Temperature: -40C to + 70C  
 Hydraulic Magnetic Operating Temperature: -40C to + 85C

## Standards & Certifications

CSA-C22.2 No. 5-02  
 EMC Compatible  
 FCC  
 RoHS  
 UL 489, HACR rated  
 UL 943 (GFCI), where applicable  
 UL 1699 (AFCI), where applicable

## ORDERING INFORMATION

### Standard



Amp Rating	1-Pole 120V	2-Pole 120/208V 120/240V
15	LB115-T	LB215-T
20	LB120-T	LB220-T
25	LB125-T	LB225-T
30	LB130-T	LB230-T
35	-	LB235-T
40	-	LB240-T
45	-	LB245-T
50	-	LB250-T
60	-	LB260-T
70	-	LB270*
80	-	LB280*
90	-	LB290*
100	-	LB200*
110	-	LB211*
125	-	LB212*

### AFCI



Amp Rating	1-Pole 120V	2-Pole 120/240V
15	LB115-AFT	LB215-AF*
20	LB120-AFT	LB220-AF*

### AFCI/GFCI - Dual Function



Amp Rating	1-Pole 120V
15	LB115-DFT
20	LB120-DFT

### GFPE - 30 mA Ground-Fault - Protection of Equipment



Amp Rating	1-Pole 120V	2-Pole 120/240V
15	LB115-EPT	LB215-EP*
20	LB120-EPT	LB220-EP*
25	LB125-EPT	LB225-EP*
30	LB130-EPT	LB230-EP*
40	-	LB240-EP*
50	-	LB250-EP*
60	-	LB260-EP*

### GFCI - 5 mA Ground-Fault - Protection of Personnel



Amp Rating	1-Pole 120V	2-Pole 120/208V 120/240V
15	LB115-GFT	LB215-G*
20	LB120-GFT	LB220-G*
25	LB125-GFT	LB225-G*
30	LB130-GFT	LB230-G*
40	-	LB240-G*
50	-	LB250-G*
60	-	LB260-G*

### Surge Protection



Description	120V
Surge Protective Device - Two 15A 1-Pole Circuit Breakers	LSPD1-T
Surge Protective Device - Two 20A 1-Pole Circuit Breakers	LSPD2-T

\*Hydraulic Magnetic breaker technology

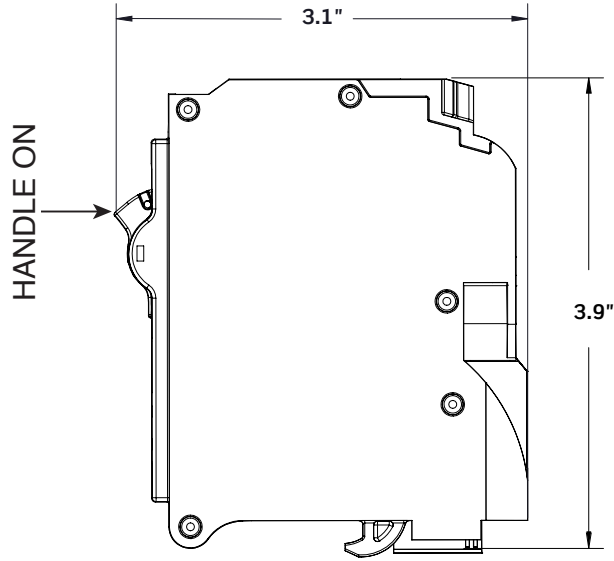
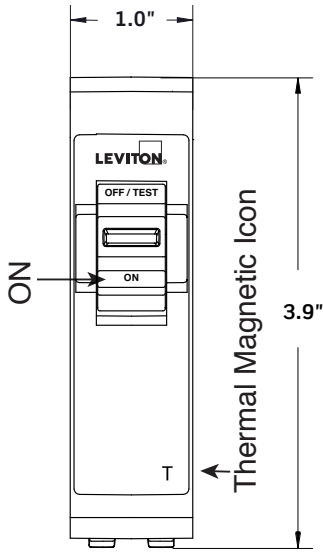

Single Pole

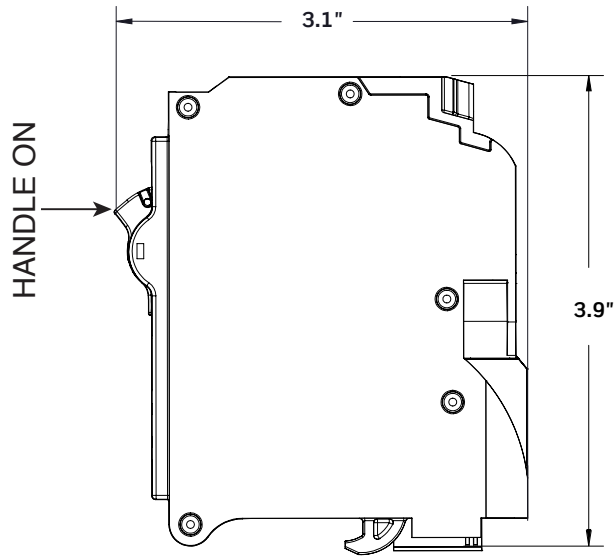
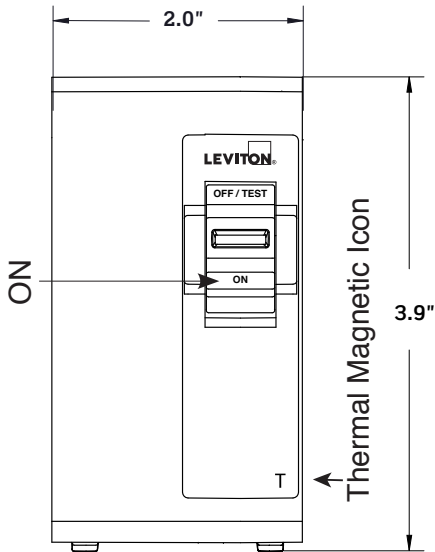

Double Pole

## HANDLE OPERATION AND LED DIAGNOSTICS

Handle Window	"AF" LED	"GF" LED	Device Status
GREEN	OFF	OFF	ON
RED	OFF	OFF	Overload or short-circuit trip
RED	ON (solid)	OFF	Series arc-fault trip
RED	OFF	ON (solid)	Ground-fault trip or Parallel arc-fault to Ground
RED	ON (blinking)	OFF	0.5 sec. delay -Parallel arc-fault trip
RED	OFF	ON (blinking)	3 sec. delay - Neutral Miswired
RED	ON (blinking)	ON (blinking)	0.1 sec. delay -Electronics self-test failure (breaker will be locked out and must be replaced)
WHITE	OFF	OFF	Manual OFF



Leviton Manufacturing Co., Inc.

Tech Line: 1-800-824-3005

Mon-Fri 8am-10pm EST, Saturday 9am-7pm EST, Sunday 9am-5pm EST

For 24/7 product support visit [www.leviton.com/support](http://www.leviton.com/support)

Visit our Website at: [www.leviton.com/loadcenter](http://www.leviton.com/loadcenter)

© 2023 Leviton Manufacturing Co., Inc. All rights reserved.  
All trademarks are the property of their respective owners.

