



TOOLS@HEIGHT 1/2" DRIVE EXTENSIONS AND ACCESSORIES

High-Polished Chrome Finish

Product Code	Description	Length (Inches)	Weight (lbs.)
S-102P-TH	Extension	2	.38
S-110P-TH	Extension	5	.50
S-115P-TH	Extension	10	.93
S-121P-TH	Extension	20	1.76
S-140A-TH	Universal Joint	2 11/16	.29

Fed. Spec: ANSI B107.10M

Features

- Chrome plating provides increased protection from rust and corrosion.



S-140A-TH



S-121P-TH



TOOLS@HEIGHT 1/2" DRIVE SHALLOW 12 POINT SOCKETS, SAE

High-Polished Chrome Finish

Product Code	Size (Inches)	OAL (Inches)	A	B	C	D	E	F	Weight (lbs.)
			Drive End Diameter (Inches)	Working End Diameter (Inches)	Broach Depth (Inches)	Bolt Clearance Depth (Inches)	Bolt Clearance Diameter (Inches)	Nose Length (Inches)	
32212-TH	3/8	1 1/2	7/8	5/8	1/2	25/32	5/16	23/32	0.11
32214-TH	7/16	1 1/2	7/8	11/16	1/2	27/32	13/32	11/16	0.12
32216-TH	1/2	1 1/2	7/8	3/4	17/32	27/32	15/32	23/32	0.12
32218-TH	9/16	1 1/2	7/8	13/16	17/32	27/32	17/32	11/16	0.12
32220-TH	5/8	1 1/2	29/32	29/32	17/32	27/32	9/16	-	0.14
32222-TH	11/16	1 1/2	31/32	31/32	9/16	27/32	21/32	-	0.16
32224-TH	3/4	1 1/2	1	1	3/4	29/32	23/32	-	0.19
32226-TH	13/16	1 1/2	1 1/8	1 1/8	25/32	31/32	25/32	-	0.21
32228-TH	7/8	1 5/8	1 3/16	1 9/16	7/8	1 1/32	7/8	-	0.25
32230-TH	15/16	1 5/8	1 1/4	1 1/4	7/8	1 5/32	29/32	-	0.29
32232-TH	1	1 5/8	1 5/16	1 5/16	7/8	1 3/16	31/32	-	0.32
32234-TH	1 1/16	1 3/4	1 7/16	1 7/16	31/32	1 9/32	1 1/16	-	0.40
32236-TH	1 1/8	1 3/4	1 1/2	1 1/2	31/32	1 5/16	1 3/32	-	0.44
32238-TH	1 3/16	1 3/4	1 9/16	1 9/16	31/32	1 5/16	1 1/4	-	0.50
32240-TH	1 1/4	1 3/4	1 11/16	1 21/32	31/32	1 5/16	1 1/4	-	0.55
32242-TH	1 5/16	1 47/64	1 1/2	1 47/64	59/64	59/64	1 3/16	-	0.56
32244-TH	1 3/8	1 47/64	1 37/64	1 59/64	59/64	59/64	1 17/64	-	0.64
32246-TH	1 7/16	1 31/32	1 21/32	1 57/64	1 1/16	1 1/16	1 11/32	-	0.66
32248-TH	1 1/2	1 31/32	1 11/16	1 31/32	1 1/8	1 1/2	1 1/8	-	0.72

Fed. Spec: ANSI B107.1

Features

- SUPERTORQUE® lobular openings for greater turning power without deforming the fastener.
- Designed for quick engagement on both 6 and 12 point fasteners.



32220-TH

32212-TH

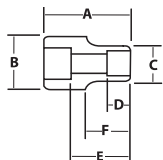

Competitor's socket Williams socket

Williams T@H sockets, extensions, and adaptors feature a locking hole on all four sides, not just one. Williams T@H ratchets and drive tools feature a locking pin which mates with the side lock hole for positive retention. This reduces the risk of misaligning the socket that typical competitor's sockets with just one side hole create.

Release pin with WTHPRT - Pin Release Tool for William's Square Drive Tools

Do not use quick release tools with locking collars or push button release. These tools can be disengaged inadvertently.



WTHPRT

TOOLS@HEIGHT

SOCKETS