

/ LED INDICATORS



LED	Colour	Status	Description
POWER 1 / 2	Blue	Off	Power Input 1 / 2 Not Present
		On	Power Input 1 / 2 Present
FAULT	Red	Off	Selected Power Input(s) Good
		On	Power Input Fault



SCAN ME



/ FAULT BYPASS SWITCHES

Remove the white DIP switch protection cap to access the two DIP switches.

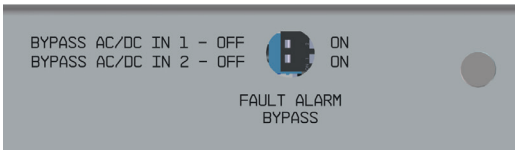

Turn the DIP switch to the ON position for any power input that is not connected.

When the DIP switch is in the ON position that power input will be ignored for the purposes of alarm condition monitoring. When that power input is not present then the Fault LED and Fault Relay output will not trigger.

/ BLADE CARDS & BLANK PANELS (SOLD SEPARATELY - EXAMPLE MODELS ONLY)

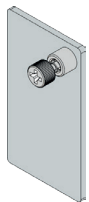

AMG260B-BP1

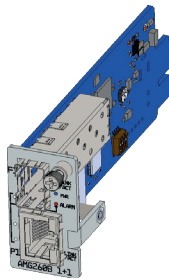

AMG260B-1G-1S

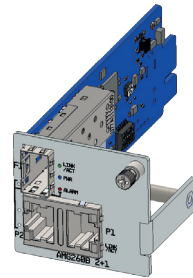

AMG260B-2G-1S

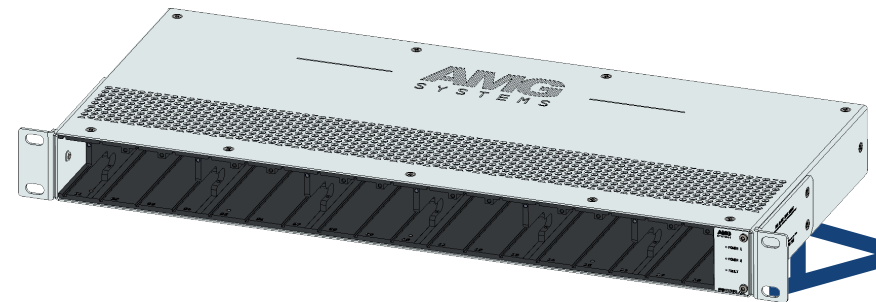

# AMG2036 Series Industrial Blade Chassis

Installation Manual - Hardware



AMG2036

## / 19-INCH RACK MOUNT INSTALLATION

① Attach the 2 x rack mount lugs with the provided 6 x M3×6mm fixing screws as shown.

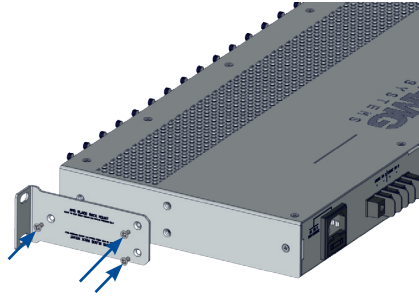

② Only use the M3×6mm screws provided as longer screws could cause damage to the blade cards when inserted or removed from the chassis.



③ Fix the unit into the 19inch rack using 4 x M6 cage nuts and bolts (not included)

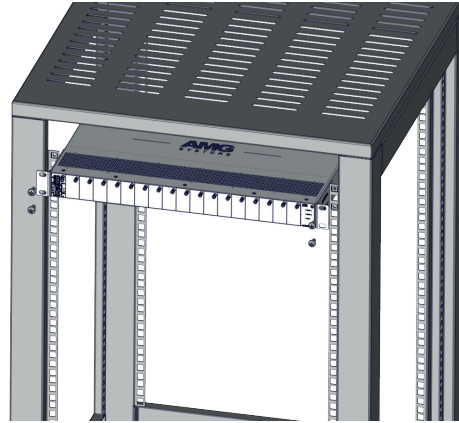

## / WALL MOUNTING

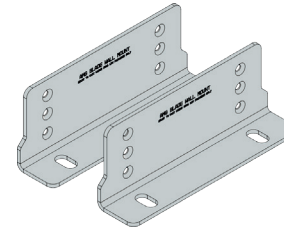

An optional wall mounting kit is available. This allows for flat-to-wall mounting in multiple orientations. Fix the 2 x wall brackets to the AMG2036 chassis using the 6 x M3×6mm screws provided in the wall mount kit.

Order Part Code: AMGMNT-WALL-02

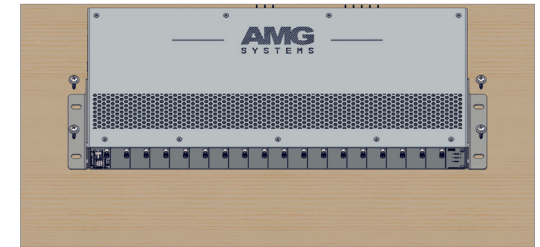
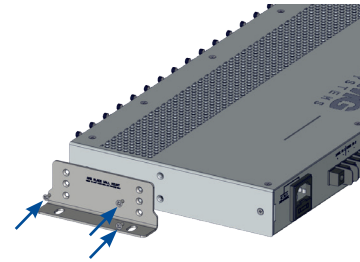

## / POWER & FAULT RELAY

AMG2036-RP-AA

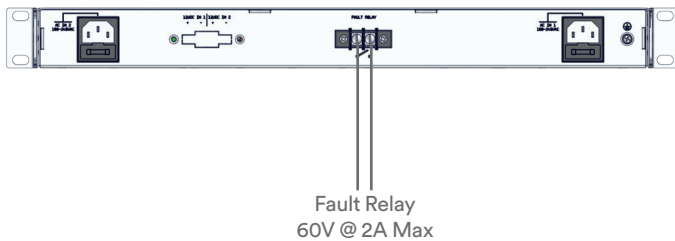

Power Input	Voltage	Current
AC Input 1	85-264 VAC	2.3A 115VAC Max 1.1A 230VAC Max
AC Input 2	85-264 VAC	2.3A 115VAC Max 1.1A 230VAC Max

AMG2036-RP-AD

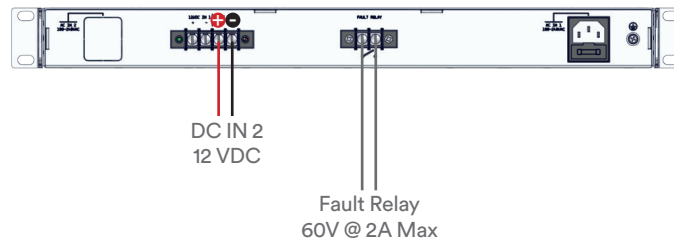

Power Input	Voltage	Current
AC Input 1	85-264 VAC	2.3A 115VAC Max 1.1A 230VAC Max
DC Input 2	12 VDC	4.6A Max

AMG2036-RP-DD

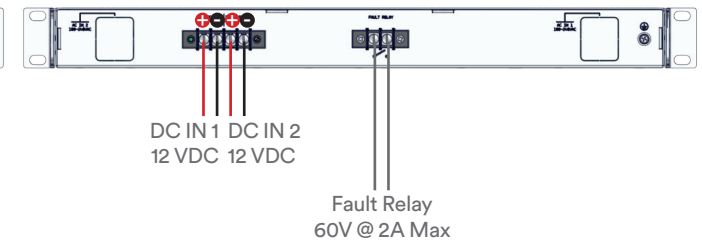

Power Input	Voltage	Current
DC Input 1	12 VDC	4.6A Max
DC Input 2	12 VDC	4.6A Max



**Warning**  
Check Polarity Before Powering