

# TURING IP SPEAKER

All-In-One Outdoor IP Speaker

TP-AD-STSP

## KEY FEATURES

- ✓ All-in-One Visual + Audio Deterrence Device
- ✓ Powerful Edge Hardware (NDAA Compliant)
- ✓ Flexible Power & Installation
- ✓ Fully Customizable RGB Lighting
- ✓ Two-Way Audio + Broadcast Capability
- ✓ Advanced Alarm Linkage & Automation
- ✓ VMS & Platform Integration Ready



### Up to 45 Watt Max

Combine video & audio systems into a single proactive security solution.

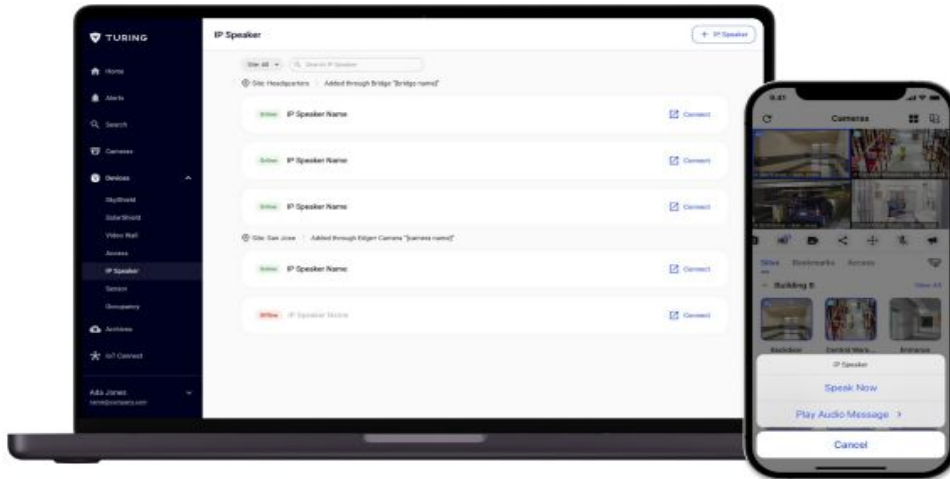

## KEY FEATURES



Up to 120 dB maximum sound pressure level with 20 Hz–20 kHz frequency response — suitable for large parking lots, warehouses, and campus environments



Supports AAC, G.711u, and G.711a for interoperability with mainstream VMS/NVR platforms and SIP-based systems



Built-in dual mic design allows listen-back verification, improving remote intervention workflows and reducing false dispatch



Granular time-based configuration for both alarm-triggered behavior and idle-mode behavior — enabling day/night policy differentiation



LAN-based Broadcast Linkage allows one triggered device to activate other IP speakers on the same network — scalable for multi-zone deployments



Supports DC 9–36V input, ideal for solar-powered poles, mobile trailers, and off-grid surveillance deployments.



Supports IPv4, IPv6, DHCP, RTSP, RTP, SNMP, NTP, SIP, and ONVIF, making it compatible with enterprise and public safety network environments



Turing Vision Integrated – Triggers audio and strobe alerts directly from platform alarm events

GENERAL	
<b>Dimensions (LxWxH)</b>	146 mm × 146 mm × 54.5 mm <i>(Including installation plate)</i>
<b>Weight</b>	5.4lbs
<b>Working Environment</b>	-30°C to +60°C (-22°F to +140°F)
<b>Rating</b>	IP66

POWER	
<b>Standard Output Power</b>	PoE++ (IEEE 802.3bt compliant) Voltage range: 9–36V DC  Up to 45W Max (Including strobe lights)

SOUND RATING	
<b>Maximum Sound Pressure Level (SPL)</b>	120dB
<b>Frequency Range</b>	20 Hz – 20 kHz
<b>Amplifier Power Output</b>	24W
<b>Audio Codec Support</b>	AAC / G711u / G711A
<b>Microphone Type</b>	Dual-microphone array supporting two-way audio

FUNCTION	
<b>Audio File Format</b>	MP3, WAV
<b>NTP Timing</b>	Support
<b>Broadcast</b>	Supported (triggered via linkage events)
<b>Two-Way Audio</b>	Support

<b>Strobe Lighting Pattern</b>	Steady 1 Sec Blink 2 Sec Blink 5 Sec Blink Breathe Strobe (adjustable frequency)
	Additional capabilities: Dual-color strobe (e.g., Red + Blue alternating) Adjustable brightness Adjustable strobe frequency

NETWORK	
<b>Network Protocol</b>	IPv4; IPv6; DHCP; ARP; RTSP; RTP; SNMP; NTP; HTTP (Port 80); HTTPS (Port 443);
<b>Communication Method</b>	Wired
<b>Interface Protocol</b>	ONVIF; SIP
<b>Supported Platform</b>	Turing Vision

INTERFACE	
<b>Alarm</b>	Alarm In x 1; Alarm Out x 1
<b>Ethernet</b>	10/100M Base-TX RJ45
<b>Power Output</b>	No power output
<b>Local Storage</b>	8GB eMMC (internal storage)
<b>Reset Button</b>	Yes

INSTALLATION	
<b>Mounting Options</b>	Surface Mount (plate included, see dimensions below)

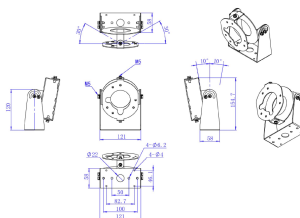
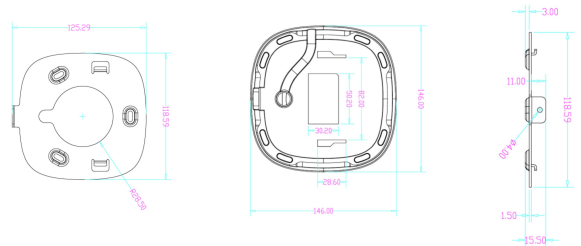

**Note:**

A Turing IP Speaker license isn't required for Turing Vision to add Turing IP Speakers, but a CORE AI license is required to map cameras with Turing IP Speakers

Unit comes with mounting brackets, rain shield is ordered separately. Model number of rain shield: TP-SH-STSP