

DESCRIPTION

Nascom's N1175 UM 400 Series is an ultra-mini 3/8" recessed contact, designed to protect all nonferrous (e.g. wood, aluminum and vinyl) doors and windows, in both residential and commercial settings.

The N1175 UM 400, our shortest 3/8" press fit, is the installer's choice of contact configuration where drill depth is critical and excellent air and side-to-side gaps are required to prevent false alarms caused by shifting or warping doors and windows.

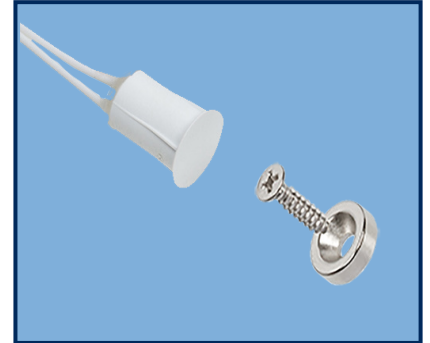

FEATURES

- PRESS FIT SWITCH - NO GLUE REQUIRED
- 12" 22AWG WIRE LEADS
- WIDE GAP - N35 NdFeB RARE EARTH MAGNET
- ENCAPSULATED HERMETICALLY SEALED CONTACTS
- POLYPROPYLENE HOUSINGS
- LISTED TO UL634 STANDARD

ORDERING INFORMATION

PART NUMBER	COLOR	OPERATE GAP (in inches)	CONTACT RATING (Max DC/Peak AC Resistive)				STATIC CONTACT RESISTANCE (50mV, 100mA)
			SWITCHING		CARRY		
			V	I	V	I	

CLOSED LOOP, NORMALLY OPEN, 1FA, SWITCH/MAGNET SET:

N1175UM400B/ST N1175UM400G/ST N1175UM400W/ST	BROWN GREY WHIITE	0.375 to 0.750	200 VDC	0.5 Amps	10vA	1.5 Amps	150 mOhms
--	-------------------------	----------------	---------	----------	------	----------	-----------

HIGH SECURITY, NORMALLY OPEN, 1FA, SWITCH/MAGNET SET:

N1175UM400B/STHS N1175UM400G/STHS N1175UM400W/STHS	BROWN GREY WHIITE	0.1875 to 0.50	300 VDC	0.20 Amps	3vA	0.5 Amps	150 mOhms initial
--	-------------------------	----------------	---------	-----------	-----	----------	-------------------

WIRING SCHEMATIC

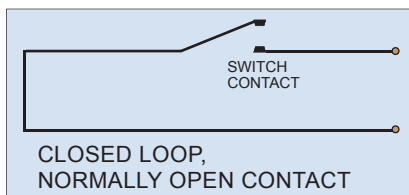

DIMENSIONS - IN [mm]

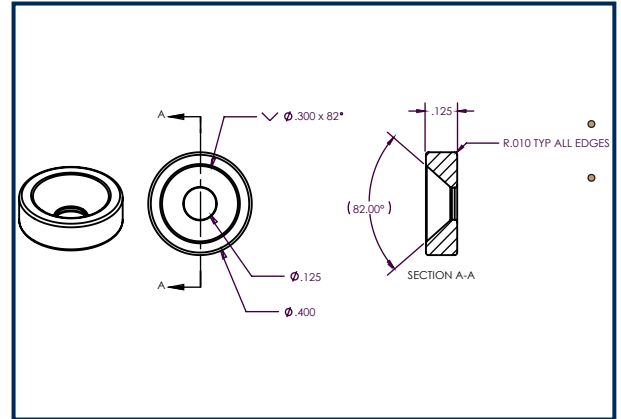
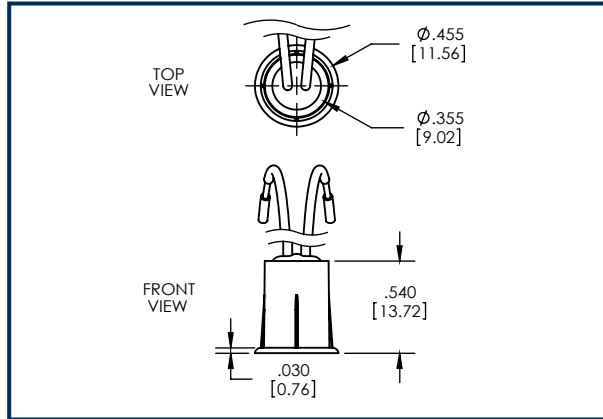

MAGNET

INSTALLATION INSTRUCTIONS

- Mark location for the switch on the door frame and mark the location for the magnet on the top edge of the door.
- Make sure switch and magnet hole locations are aligned.
- Using a square, transfer the marks on to the top edge of the door and the opposing door frame.
- Using a tape measure or graduations on the square, locate the center of the door edge and place an intersecting line with the first mark. Mount the donut magnet using the #4X1/2 flathead screw provided.
- Repeat the above step to locate the hole position for the switch in the door frame. Drill a 3/8" hole in the door frame.
- Connect the switch leads to the alarm system. **Caution! Hold wire leads, not the switch housing while cutting and stripping to prevent damage to switch.**
- Insert wire leads into hole followed by the switch and press the switch into the hole until the head is flush with the door frame
- Test switch for correct operation and make sure gap performance is acceptable.

PART NUMBERING SYSTEM

