



# CDVI

Security to Access



**VHESF**  
**VHESS**

*Infrared exit switch*



RoHS

**EN** **SE** **DK**

## 1] PRODUCT PRESENTATION

- **Infrared request to Exit Switch.**
- **Stainless steel.**
- **Range:** 25 to 50cm.
- **Visual feedback:** - Blue, in stand-by,  
- Green during activation.
- **Audible feedback.**
- **Time control:** 2 to 2,5 sec.
- **Internal/external use.**
- **Available in versions :**
  - Flush mount (VHESF),
  - Surface mount (VHES).
- **Input voltage:** 9-24Vdc.
- **Consumption:**
  - stand-by = 25mA.
  - in activation = 65mA.

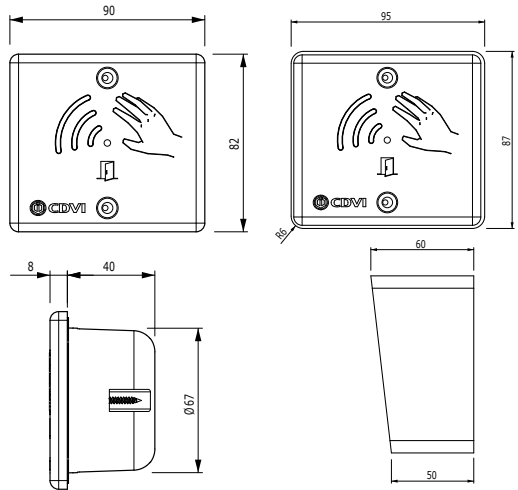

### Recommended power supplies

 -30°C to +70°C

 IP42

**H.R.V.**  
 HIGH RESISTANCE  
 TO VANDALISM

## 2] NOTES & RECOMMENDATIONS

### Usage

Contact with the product is not necessary. the switch is activated by a simple movement of the hand, up and down at a distance.





### Recommended cables

Recommended 8/10<sup>th</sup> cable (AWG20).

### Mounting

To optimize the setting of the product and prevent attempts to pull, choose flat surfaces.

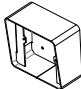
## 3] MOUNTING KIT

						
	VHES front side	Diaux® screw	Flush mount box	surface mount box	Diaux® key	M4x6 screw
VHES	1	2	-	1	1	2
VHESF	1	2	1	-	1	-

### 4] MOUNTING

VHESF

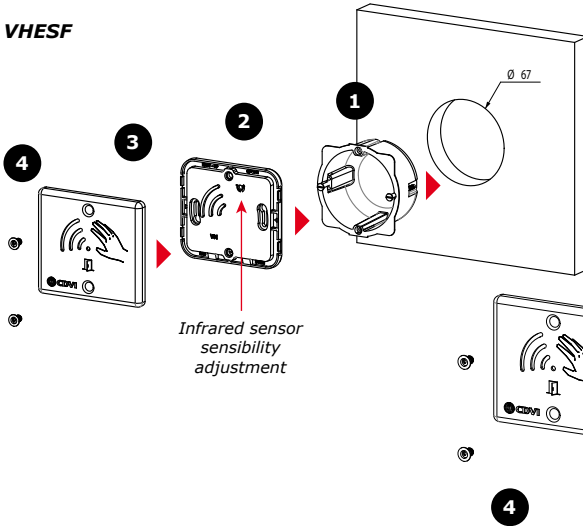

VHES

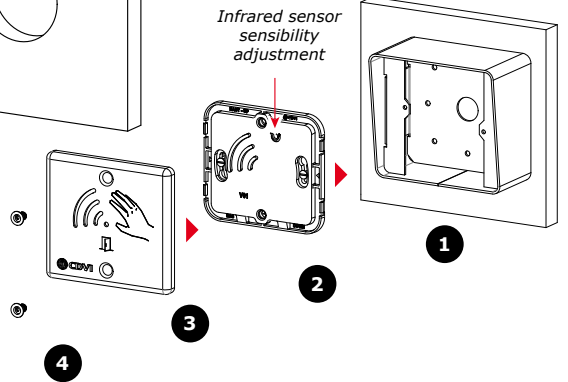

### 5] WIRING AND ADJUSTMENT

BACK SIDE

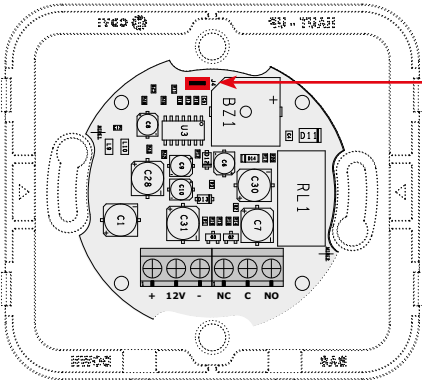

To shut down the buzzer, cut the strap



Infrared sensor sensibility adjustment

Minimum 25cm - + Maximum 50cm

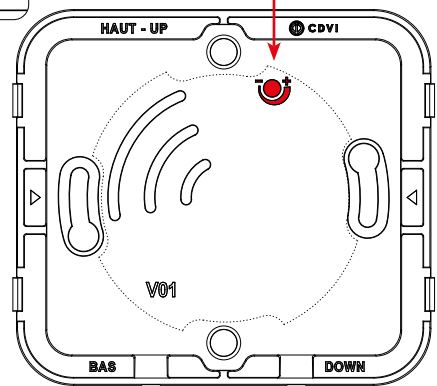

FRONT SIDE

TERMINAL

+	Input voltage 9-24Vdc
-	Input voltage 0V
NC	Normally closed contact
C	Common
NO	Normally open contact

## 1] PRODUKTSPECIFIKATION

- **Infraröd öppn knapp.**
- **Rostfritt stål.**
- **Avstånd:** 25 till 50cm.
- **LED indikering:** - Blå, i stand-by,  
- Grön vid aktivering.
- **Ljud indikering.**
- **Tidinställning:** 2 till 2,5 sek.
- **För både inom- och utomhus bruk.**
- **Finns i olika utföranden :**
  - Infällt montage (VHESF),
  - Utanpåliggande montage (VHESS).
- **Spänningsmatning:** 9-24Vdc.
- **Strömförbrukning:**
  - stand-by = 25mA.
  - vid aktivering = 65mA.

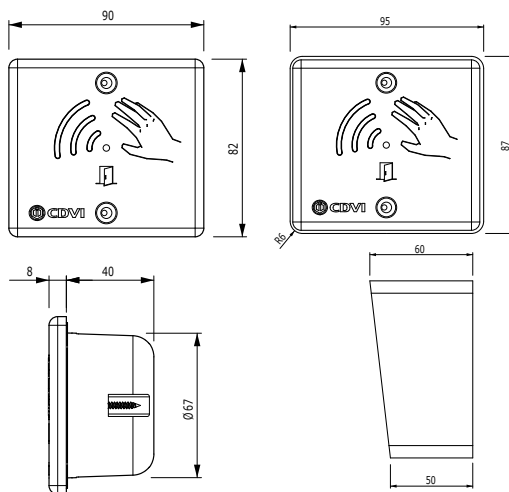

### Rekommenderade nättaggregat

 -30°C till +70°C

 IP42

**H.R.V.**  
 HIGH RESISTANCE  
 TO VANDALISM

## 2] INFORMATION OCH REKOMMENDATIONER

### Användning

Du behöver inte vidröra produkten vid användning, öppnknappen aktiveras av att du rör handen en bit ifrån öppnarknappen.





### Rekommenderat kablage

Rekommenderad 8/10<sup>th</sup> kabel (AWG20).

### Montage

För att få en bra funktion och förhindra sabotage skall produkten monteras på en plan yta.

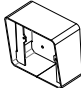
## 3] MONTERINGSSATS

						
	VHES framsida	Diax® skruv	Apparatdosa	Låda för utanpåliggande montage	Diax® nyckel	M4x6 skruv
VHESS	1	2	-	1	1	2
VHESF	1	2	1	-	1	-



## 1] PRODUKTSPECIFIKATION

- **Infrarød åbneknop**
- **Rustfrit stål.**
- **Rækkevidde:** 25 til 50 cm.
- **Visuel feedback:** - Blå, i standby.  
- Grøn, i aktiv tilstand.
- **Hørbar feedback.**
- **Tidsindstilling:** 2 til 2,5 sek.
- **Indendørs- /udendørsbrug.**
- **Fås i følgende versioner:**
  - Indfældet montering (VHESF).
  - Overflademontering (VHES).
- **Input-spænding:** 9-24V DC.
- **Forbrug:**
  - standby = 25mA.
  - ved aktivering = 65mA.

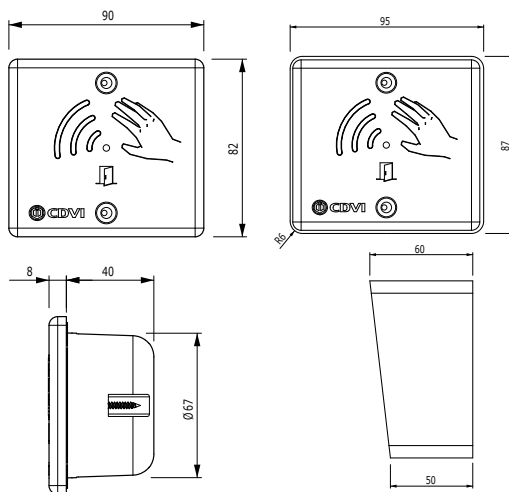

### Anbefalede strømforsyninger

 -30°C til +70°C

 IP42

## 2] INFORMATION OG ANBEFALINGER

### Brug

Direkte kontakt med produktet er ikke nødvendig. Knappen aktiveres ved bevægelse af hånden, op og ned, på afstand.





### Anbefalede kabler

Vi anbefaler 8/10<sup>th</sup> kabel (AWG20).

### Montering

For den bedste funktion og for at forhindre sabotage bør produktet monteres på en plan overflade.

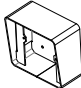
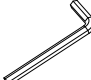
## 3] MONTERINGSKIT

						
	VHES-forside	Diax® skrue	Box, indfældet montering	Box, overflade-montering	Diax® nøgle	Nøgle M4x6
VHES	1	2	-	1	1	2
VHESF	1	2	1	-	1	-

## 4] MONTERING

VHESF

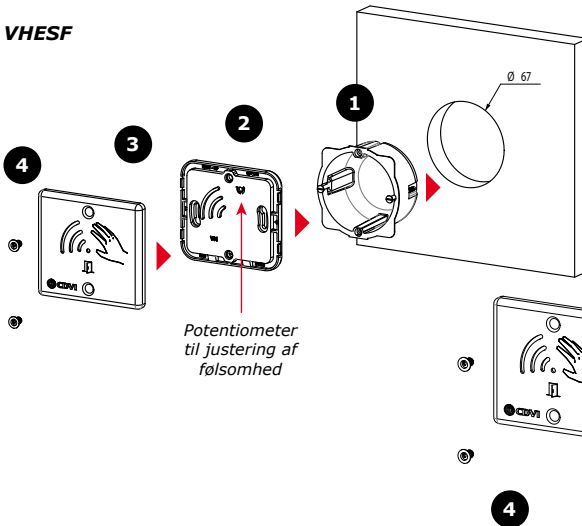

VHES

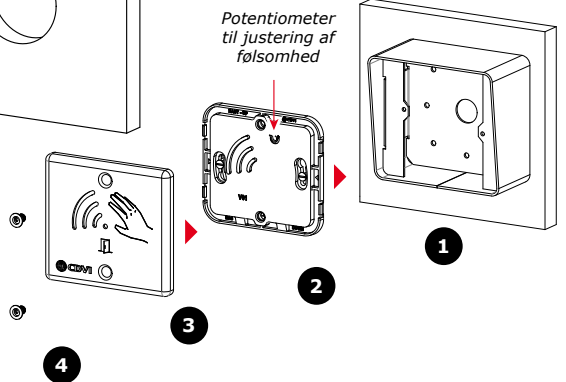

## 5] FORBINDELSER OG JUSTERINGER

BAGSIDEN

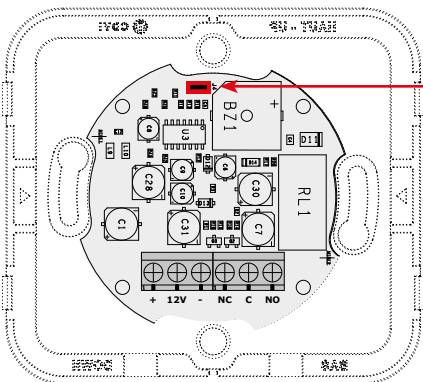

For at blokere summeren, klip kablet over



Potentiometer til justering af følsomhed

Min. 25cm - + Max. 50cm

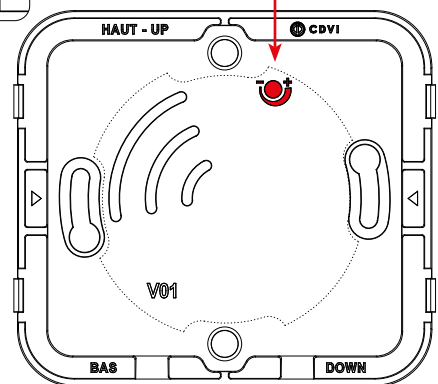

FORSIDEN

FORBINDELSER

+	Spænding: 9-24V DC
-	Spænding: 0V DC
NC	Normalt lukket kontakt
C	Fælles
NO	Normalt åben kontakt

**CDVI Group**

FRANCE (Headquarters)

Phone: +33 (0) 1 48 91 01 02

.....

**CDVI FRANCE + EXPORT**

+33 (0) 1 48 91 01 02

[www.cdvi.com](http://www.cdvi.com)

**CDVI AMERICAS [CANADA - USA]**

+1 (450) 682 7945

[www.cdvi.ca](http://www.cdvi.ca)

**CDVI BENELUX [BELGIUM - NETHERLANDS - LUXEMBOURG]**

+32 (0) 56 73 93 00

[www.cdviBenelux.com](http://www.cdviBenelux.com)

**CDVI TAIWAN**

+886 (0) 42471 2188

[www.cdviChina.cn](http://www.cdviChina.cn)

**CDVI SUISSE**

+41 (0) 21 882 18 41

[www.cdvi.ch](http://www.cdvi.ch)

**CDVI CHINA**

+86 (0) 10 84606132/82

[www.cdviChina.cn](http://www.cdviChina.cn)

**CDVI IBÉRICA [SPAIN - PORTUGAL]**

+34 (0) 935 390 966

[www.cdviIberica.com](http://www.cdviIberica.com)

**CDVI ITALIA**

+39 (0) 321 90 573 - [www.cdvi.it](http://www.cdvi.it)

**CDVI MAROC**

+212 (0) 5 22 48 09 40

[www.cdvi.ma](http://www.cdvi.ma)

**CDVI NORDICS [SWEDEN - DENMARK - NORWAY - FINLAND]**

+46 (0) 31 760 19 30

[www.cdvi.se](http://www.cdvi.se)

**CDVI UK [UNITED KINGDOM - IRELAND]**

+44 (0) 1628 531300

[www.cdvi.co.uk](http://www.cdvi.co.uk)

**CDVI POLSKA**

+48 (0) 12 659 23 44

[www.cdvi.com.pl](http://www.cdvi.com.pl)

*All the information contained within this document (pictures, drawings, features, specifications and dimensions) could be perceptibly different and can be changed without prior notice.*