

CDO100 – Cablofil Center Style Dropout - *Installation Instructions*

Installation before cables installed;

- Remove necessary wire mesh wires as shown in Illustration 1
- Bend side tabs 90° on CDO100 to close fourth side as shown in Illustration 2
- Install CDO100 from top wide of wire mesh into opening created as shown in Illustration 2
- *Snap* CDO100 onto wire mesh as shown in Illustration 2, bend top tabs around cross wires if necessary (bolt into position if bonding is required)
- Install bolt (facing outward) in overlapped slot(s) mentioned in bullet 2, attach nut and tighten to secure closure
- Connect vertical cable management member if needed

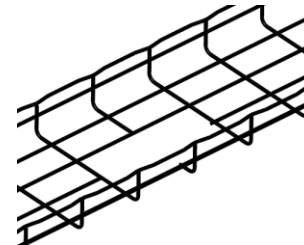

Illustration 1

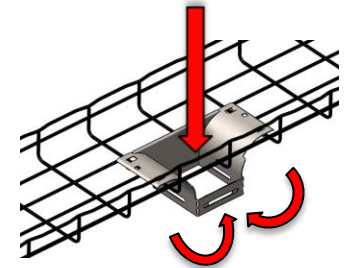

Illustration 2

Installation after cable installed;

- Leave CDO100 open (as when shipped)
- Remove necessary wire mesh wires as shown in Illustration 1
- Position CDO100 around cables *exiting* the wire mesh
- Tilt CDO100 to fit inside of hole created in bullet 2 (slide side-to-side into position)
- *Snap* CDO100 down onto wire mesh as shown in Illustration 3, bend top tabs around cross wires if necessary (bolt into position if bonding is required)
- Bend front tabs 90° to close (toward each-other/overlap), install bolt (outward) in slot(s), attach nut and tighten to secure closure
- Connect vertical cable management member if needed as shown in Illustrations 4

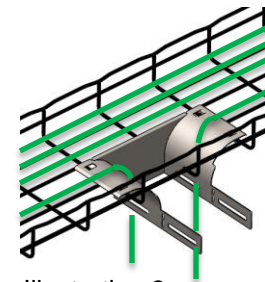

Illustration 3

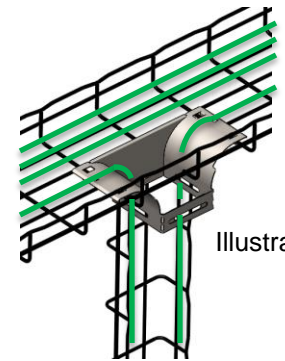

Illustration 4

Installation using *Ortronics tube cap and tube* as shown in Illustration 5:

- Remove necessary wire mesh wires as shown in Illustration 1
- Bend tabs 180° opposite each other as shown in Illustration 5
- Install CDO100 from top side of wire mesh into opening created as shown in Illustration 5
- *Snap* CDO100 onto wire mesh as shown in Illustration 5, bend top tabs around cross wires if necessary (bolt into position if bonding is required)
- Connect vertical tube as shown in Illustration 6

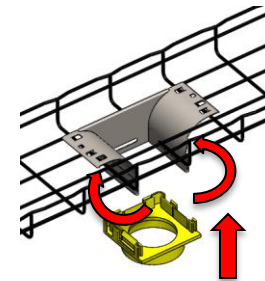

Illustration 5

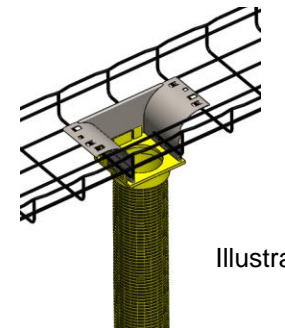

Illustration 6