

GV-TMS8800 AI 2 x 4MP Dual-Sensor Multi-Directional H.265 Super Low Lux WDR Pro IR Fixed IP Dome



- AI deep learning: AI Perimeter Protection & Classification (Human, Vehicle)
- 1/3" progressive scan super low lux CMOS sensor
- Triple streams from H.265, H.264 or MJPEG
- Min. illumination at 0.002 lux
- Up to 25 fps at 2688 x 1520
- Wide Dynamic Range Pro (WDR Pro)
- Day and night function (with removable IR-cut filter)
- Intelligent IR
- IR distance up to 30 m (100 ft)
- Built-in microSD card slot (SD / SDHC / SDXC / UHS-I, Class 10) for local storage
- 3-axis mechanism (pan / tilt / rotate)
- Ingress protection (IP67)
- Vandal Resistance (IK10 for metal casing)
- DC 12V / PoE (IEEE 802.3af)
- Built-in microphone
- Two-way audio capable
- Defog
- 3D noise deduction
- AI analytics (Intrusion, Cross Line, Enter Area, Leave Area, Face Detection, People Flow Counting, Crowd Density Monitoring)
- Motion detection
- Tampering alarm
- Text overlay
- Privacy mask
- 12 languages supported
- ONVIF (Profile G, S, T, M) conformant

Introduction

GV-TMS8800 features two 4MP CMOS image sensors to deliver a video resolution of 2688 x 1520 at up to 25 fps. It's an outdoor, fixed, network camera equipped with an automatic IR-cut filter and two IR LEDs for day and night surveillance. The camera supports H.265 video codec to achieve a better compression ratio while maintaining high-quality pictures at reduced network bandwidths. The camera adheres to IP67 and IK10 standards, and can be powered through PoE.

Empowered by deep learning algorithms, its AI technology distinguishes humans and vehicles from other moving objects. Integrated with GeoVision Video Management Software (VMS), it supports AI perimeter protection, real-time alerts, event playback, and more.

Deep Learning Function

Face Detection

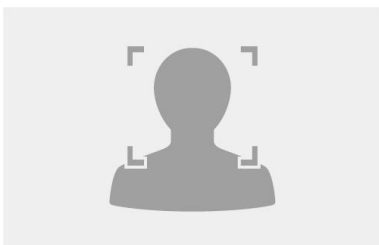

AI Perimeter Protection

(Intrusion, Crossing Line, Entering Area, Leaving Area)

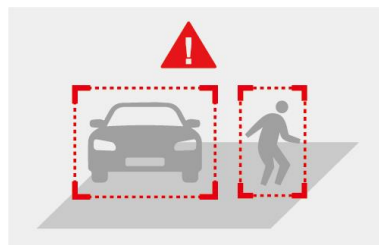

People Flow Counting



Dimensions

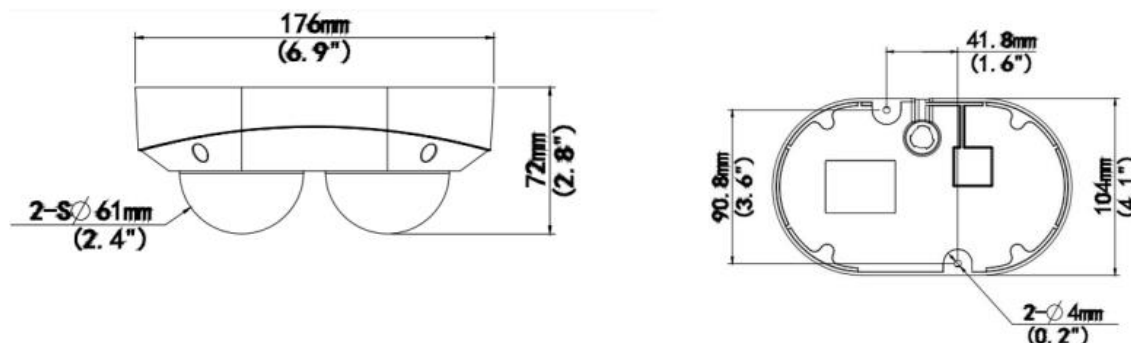

Specifications

Camera					
Image Sensor	1/3" progressive scan CMOS				
Picture Elements	2688 (H) x 1520 (V)				
Minimum Illumination	Color	0.002 Lux (F1.6, AGC ON)			
	IR ON	0 Lux			
Shutter Speed	Auto / Manual (1 ~ 1/100000 sec)				
White Balance	Automatic, Manual				
Gain Control	Automatic, Manual				
S/N Ratio	Up to 52 dB				
WDR Pro	Yes				
Dynamic Range	130 dB				
Lens					
Megapixel	4 MP for each lens				
Day / Night	Yes (with removable IR-cut filter)				
Lens Type	Fixed				
Focal Length	2.8 mm				
Maximum Aperture	F/1.6				
Mount	∅ 12 mm				
FOV	Horizontal	97.7°			
	Vertical	52.67°			
	Diagonal	102.52°			
Operation	Focus	Fixed			
	Zoom	Fixed			
	Iris	Fixed			
IR LED Quantity	2 IR LEDs				
Max. IR Distance	30 m (100 ft)				
DORI		Detect	Observe	Recognize	Identify
Lens	2.8 mm	63.0 m (206.7 ft)	25.2 m (82.7 ft)	12.6 m (41.3 ft)	6.3 m (20.7 ft)
Operation					
Video Compression	H.265, H.264, MJPEG				
Video Streaming	Triple streams from H.265, H.264 or MJPEG				
Frame Rate	25 fps at 2688 x 1520, 2560 x 1440, 30 fps at 2304 x 1296, 1920 x 1080, 1280 x 720 (60 / 50 Hz) *The frame rate and performance may vary depending on the number of connections and data bitrates (different scenes).				
Maximum throughput	50 Mbps				
Maximum stream *When the total bitrate is within the maximum throughput	20				
Video Analytics	Motion Detection, Ultra Motion Detection, Tampering Alarm, Audio Detection *Tampering alarm and audio detection are only accessible through the camera's Web interface, which can be used to trigger alerts such as e-mail and FTP				
Image Setting	Brightness, Saturation, Contrast, Sharpness, Flicker-less, Image Orientation (Flip, Mirror, 0°, 90°, 180°, 270° -including Corridor format)				
Audio Compression	G.711				

Audio Support	Two-way Audio (external speaker required)	
Digital I/O	Input	1 Input, dry contact, NO/NC
	Output	1 Relay Output (DC 30V, 1A / AC 125V, 0.3A)

Deep Learning Function

AI Analytics	Sensor 1	<ul style="list-style-type: none"> - <u>Perimeter Protection</u> (Human & Vehicle classification): Cross Line, Enter Area, Leave Area, Intrusion - <u>Face Detection</u>, <u>People Flow Counting</u>, <u>Crowd Density Monitoring</u>
	Sensor 2	<ul style="list-style-type: none"> - <u>Perimeter Protection</u> (Human & Vehicle classification): Cross Line, Enter Area, Leave Area, Intrusion

*Within a sensor, all Perimeter Protection rules can be enabled together. However, due to hardware resource limitations, only one AI function per sensor can be enabled at a time: Perimeter Protection, Face Detection, People Flow Counting, or Crowd Density Monitoring.

*Each sensor can have an AI function enabled independently.

Network

Interface	10/100 Ethernet
Protocol	802.1X (including EAP-TLS), ARP, DHCP, DDNS, DNS, DynDNS, FTP, HTTP, HTTPS, ICMP, IGMP, IPv4, IPv6, NTP, PPPoE, QoS, RTCP, RTP, RTSP, SMTP, SNMP, TCP, UDP, UPnP, ONVIF (Profile G, S, T, M)

Video Resolution

Main Stream	2688 x 1520 (Default), 2560 x 1440, 2304 x 1296, 1920 x 1080, 1280 x 720
Sub Stream	1280 x 720, 720 x 576, 704 x 288, 640 x 480, 640 x 360 (Default), 352 x 288
Third Stream (Closed by Default)	720 x 576, 704 x 288, 640 x 360, 352 x 288

Mechanical

Camera Angle Adjustment	Pan	0° ~ 180°	
	Tilt	0° ~ 66°	
	Rotate	0° ~ 346°	
	Power	DC Jack (DC 12V, 1.25A), PoE (IEEE 802.3af)	
	Ethernet	RJ-45	
Connectors	Audio	Built-in microphone	Yes
		External microphone required	Yes (3-pin terminal block)
		Built-in speaker	No
		External speaker required	Yes (3-pin terminal block)
	*Choose either the built-in or external microphone. *The audio in port only supports microphones with power supply.		
	Digital I/O	4-pin terminal block pitch 3.5 mm (0.14")	
	Local Storage	microSD card slot (SD / SDHC / SDXC), up to 512 GB	

General

Operating Temperature	-30°C ~ 60°C (-22°F ~ 140°F)
Humidity	0% ~ 95% (no condensation)
Power Source	DC 12V, 1.25A / PoE (IEEE 802.3af)
Max. Power Consumption	9.1 W
Dimensions	176 × 104 × 72 mm (6.9" × 4.1" × 2.8")
Weight	0.62 kg (1.37 lb)
Ingress Protection	IP67
Vandal Resistant	IK10 for metal casing
Certification	FCC, CE, RoHS, UL compliant

Web Interface

Installation Management	Web-based configuration
Maintenance	Firmware upgrade through Web Browser or GV-IP Device Utility
Access from Web Browser	Live View, Video Recording, Change Video Quality, Bandwidth Control, Image Snapshot, Defog, Text Overlay, Image Masking
Language	Chinese Traditional, Czech, English, French, German, Hungarian, Italian, Japanese, Polish, Portuguese, Russian, Spanish

Software Applications

Software Supported (by patch)	GV-VMS (V17.4.8 / V18.3.5 or later, patch files required / V20.0.0 or later), GV-Control Center (V4.2.1 or later, patch files required), GV-Edge Recording Manager Windows Version (V2.3.0 or later), GV-Recording Server / Video Gateway (V2.1.1 or later, patch files required), GV-IP Device Utility (V9.0.1 or later) *GV-TMS8800 occupies two channels of GV-VMS.
Smart Device Access	GV-Eye for iOS / Android (V3.5.0 or later)
Live Viewing	Browser (IE, Edge, Chrome, Firefox), Mobile App



Note: Specifications are subject to change without notice.

Packing List

- | | |
|-----------------------------------|--------------------------|
| 1. GV-TMS8800 Dual-sensor IR Dome | 4. Waterproof Rubber Set |
| 2. Screw Kit | 5. Torx Wrench |
| 3. Drill Template Paster | 6. Download Guide |

Accessories

Model No.	Name		Details
GV-Mount107 (must be used with GV-Mount511)	Pendant Mount		Dimensions: Φ 120 x 334 mm (Φ 4.72" x 13.15") Weight: 0.74 kg (1.63 lb)
GV-Mount211-12	Wall Mount and Junction Box		Dimensions: 229.3 x 126.7 x 126.4 mm (9.0" x 5.0" x 5.0") Weight: 1.02 kg (2.25 lb)
GV-Mount211-16	Wall Mount and Junction Box		Dimensions: 231.4 x 125.6 x 128.8 mm (9.1" x 4.9" x 5.1") Weight: 0.88 kg (1.94 lb)
GV-Mount312 (must be used with GV-Mount211-12)	Corner Adaptor		Dimensions: 207 x 127 x 116 mm (8.1" x 5.0" x 4.6") Weight: 0.42 kg (0.93 lb)
GV-Mount312-1 (must be used with GV-Mount211-12 or GV-Mount211-16)	Corner Adaptor		Dimensions: 207 x 127 x 115.6 mm (8.1" x 5.0" x 4.6") Weight: 0.42 kg (0.93 lb)
GV-Mount420 (must be used with GV-Mount211-12)	Pole Mount Bracket		Dimensions: 120 x 120 x 53.4 mm (4.7" x 4.7" x 2.1") Weight: 0.45 kg (0.99 lb) Steel Strap Diameter: Φ 67 ~ 127 mm (Φ 2.6" ~ 5")
GV-Mount440-1 (must be used with GV-Mount211-12 or GV-Mount211-16)	Pole Mount Bracket		Dimensions: 136 x 127 x 63.6 mm (5.4" x 5.0" x 2.5") Weight: 0.34 kg (0.75 lb) Steel Strap Diameter: Φ 67 ~ 127 mm (Φ 2.6" ~ 5")
GV-Mount511	Dual-sensor Dome Junction Box		Dimensions: 176 x 107 x 48 mm (6.9" x 4.2" x 1.9") Weight: 0.24 kg (0.53 lb)

<p>GV-Mount704 (must be used with GV-Mount107)</p>	<p>Extension Tube</p>		<p>Dimensions: Ø 3.5 x 10 or 20 or 30 or 50 cm (Ø 1.38 x 3.9 or 7.9 or 11.8 or 19.7") Weight: 225g or 360g or 500g or 780g (0.5 lb or 0.79 lb or 1.1 lb or 1.72 lb)</p>
<p>GV-PA301</p>	<p>Gigabit PoE Adapter</p>		<p>GV-PA301 is a Gigabit Power over Ethernet (PoE) adapter.</p>
<p>GV-PA191</p>	<p>PoE Adapter</p>		<p>GV-PA191 is a Power over Ethernet (PoE) adapter designed to provide power to the IP device through a single Ethernet cable.</p>
<p>GV-POE Switch</p>	<p>GV-POE Switch is designed to provide power along with network connection for IP devices. The GV-POE Switch is available in various models with different numbers and types of ports.</p>		
<p>Power Adapter</p>	<p>Contact our sales representatives for the countries and areas supported.</p>		

Mounting Type

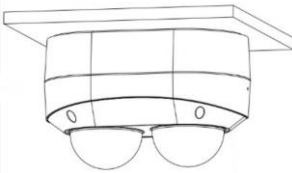
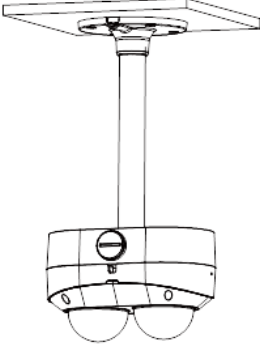
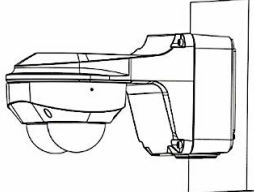
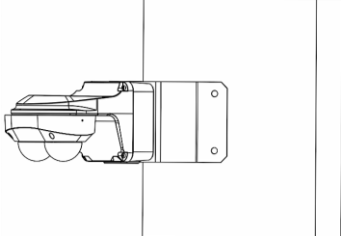
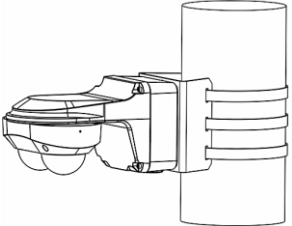
Wall / Ceiling Box Mount	Pendant Mount		Wall Mount with Junction Box	Convex Corner Mount
GV-Mount511	GV-Mount107 + GV-Mount511	GV-Mount107 + GV-Mount511 + GV-Mount704	GV-Mount211-12	GV- Mount211-12 + GV-Mount312
				
Pole Mount				
GV-Mount211-12 + GV-Mount420				
				
Wall Mount with Junction Box	Convex Corner Mount		Pole Mount	
GV-Mount211-16	GV-Mount211-16 + GV-Mount312-1		GV-Mount211-16 + GV-Mount440-1	
